

Locknut, PG thread



Locknut DIN 46320, with PG thread DIN 40430.

Note: Only tighten polystyrene locknuts lightly on account of the risk of stress crack formation.

Type	Thread	Colour	SW mm	Dimension E mm	Dimension L mm	Pack Units	Weight kg/100 pc.	Art.-Nr.
116 PG 7	Pg 7	Light grey	19	21	5	100	0,099	2043076
116 PG 9	Pg 9	Light grey	22	24	5	100	0,118	2043092
116 PG11	Pg 11	Light grey	24	26	5	100	0,113	2043114
116 PG13.5	Pg 13,5	Light grey	27	29	6	100	0,178	2043130
116 PG16	Pg 16	Light grey	30	33	6	100	0,226	2043165
116 PG21	Pg 21	Light grey	36	39	7	100	0,346	2043211
116 PG29	Pg 29	Light grey	46	50	7	50	0,573	2043297
116 PG36	Pg 36	Light grey	60	66	8	25	1,184	2043351
116 PG42	Pg 42	Light grey	65	73	8	25	1,089	2043424
116 PG48	Pg 48	Light grey	70	78	8	25	1,175	2043483

Dimensions

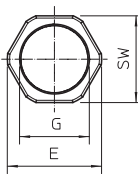
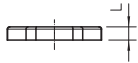

PS Polystyrene