

# Technical data sheet

Vertical bend, two-compartment, height 28 mm

Item number: 7400621



Vertical bend, two-compartment, for vertical direction changes of screed-covered underfloor ducts (wall connections, supplies).



**St** Steel

**FS** Strip galvanized

## Master data

Item number	7400621
Type	KV2 19028-2
Description 1	Vertical bend
Description 2	2 compartments for EÜK-2
Manufacturer	OBO
Dimension	270x177,7x177,7
Material	Steel
Surface	Strip galvanized
Surface standard	DIN EN 10346
Smallest sales unit	1
Unit of quantity	Piece
Weight	79.2 kg
Weight unit	kg/100 pc.

# Technical data sheet

Vertical bend, two-compartment, height 28 mm

Item number: 7400621



## Dimensions

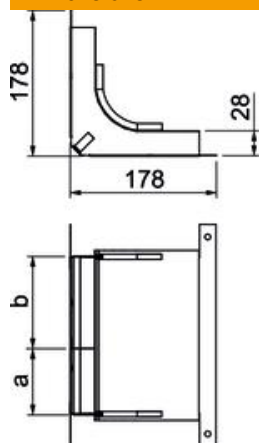

Length	178 mm
Width	190 mm
Height	28 mm
Dimension a	80 mm
Dimension b	110 mm
Dimension h	28 mm

## Technical data

Number of fixed partitions	1
Number of compartments	2 St.
Suitable for screed-flush closed underfloor ducts	no
Suitable for screed-covered underfloor ducts	yes
Trunking width, min.	190 mm
Duct height, min.	28 mm
Cross-section, draw a	1923 mm <sup>2</sup>
Cross-section, draw b	2706 mm <sup>2</sup>